



CITEL



P8AX25-716/MF



- RF coaxial surge protector
- 3.5 GHz
- 190 W
- Connectors :7/16
- Low insertion loss
- Removable GDT
- DC-pass
- Bi-directional protection

Electrical Characteristics		
Max. load current	I_L	10 A
Max. frequency	f	DC-3.5GHz
Insertion loss		< 0.2 dB
Residual Current <i>Leakage current to Ground</i>	I_{pe}	None
Max. discharge current <i>max. withstand @ 8/20 μs by pole</i>	I_{max}	20 kA
Protection mode(s)		Common mode
Protection level <i>@ In (8/20μs)</i>	U_p	< 750 V
Impulse current <i>2 x 10/350μs Test - D1 Category</i>	I_{imp}	1 kA
Nominal discharge current <i>8/20μs Test x 10 - C2 Category</i>	I_n	5 kA
Impedance		50 ohms
Max Power		190 W
Return loss		> 20 dB
VSWR		<1.2:1
Insulation resistance		≥ 10 GOhms

Mechanical Characteristics		
Technology		Gas discharge tube
Connection to Network		Connector 7/16 Male/Female
Mounting		Feedthrough
Housing material		Brass/Surface plating : Cu Zn Sn
Operating temperature		-40/+85°C
Protection rating		IP66
Outdoor application		Yes
Failsafe behavior		Short-circuit
Disconnection indicator		Transmission interrupt
Spare module(s)		BBHF-250V
Dimensions		See diagram
Contacts		Bronze/Surface Au-Ag
Insulation material		PTFE

Standards		
Standards compliance		IEC 61643-21 / EN 61643-21 / UL497C / UL497E
RohS compliance		Yes
Part Number		60404

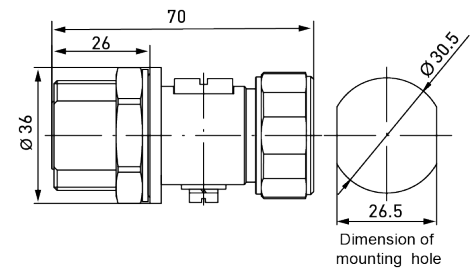

P: 2-electrode gas discharge tube