

MLPCH2-230L-V/DL

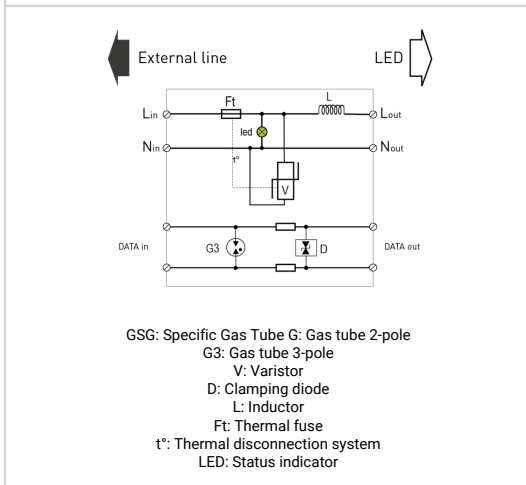

- ✦ Type 2 (or 3) surge protector for Class 2 LED Lighting
- ✦ Combined AC/Dataline surge protection
- ✦ DALI, DMX, RS485, 0-10V data lines compliance
- ✦ Optimized coordination with driver
- ✦ Compact dimensions
- ✦ Screw connection
- ✦ Max. discharge current 10 kA
- ✦ Certifié IEC 61643-11 and IEC 61643-21

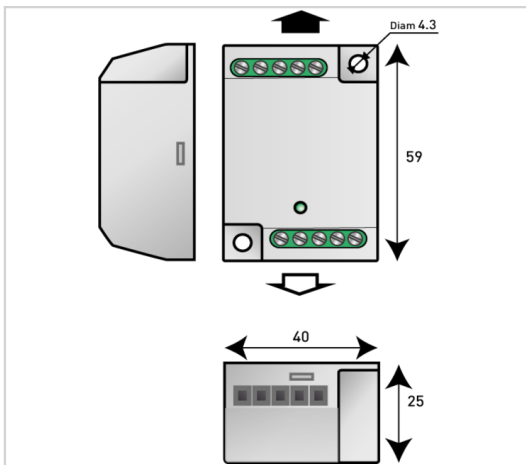

Electrical Characteristics		
Network		230 V single-phase
AC system		TT-TN
Max. Data operating voltage	Uc	28 Vdc
Max. AC operating voltage	Uc	320 Vac
Max. load current @25°C	IL	2.5 A
Temporary Over Voltage (TOV) Characteristics - 5 sec. Without disconnection	UT	335 Vac withstand
Temporary Over Voltage (TOV) Characteristics - 120 mn Without disconnection or with safety disconnection	UT	440 Vac disconnection
Residual Current Leakage current to Ground	Ipe	None
Nominal discharge current 15 x 8/20 µs impulses	In	5 kA
Max. discharge current max. withstand @ 8/20 µs by pole	Imax	10 kA
Withstand on Combination waveform IEC 61643-11 Class III test: 1.2/50µs - 8/20µs	Uoc	10 kV
Protection mode(s)		Differential Mode
Protection level @ In (8/20 µs)	Up L/L	50 V
Protection level L/N @ In (8/20µs)	Up L/N	1.5 kV
Nominal discharge current C2 Category	In	5 kA
Admissible short-circuit current	Iscrc	10 000 A
Mechanical Characteristics		
Technology		MOV+GDT
Connection to Network		By screw terminal: 1.5mm ² max.
Mounting		On plate
Housing material		Thermoplastic UL94 V-0
Operating temperature	Tu	-40/+85°C
Protection rating		IP20
Failsafe mode		Disconnection, Green Led OFF and power cut off
Disconnection indicator		LED green OFF and AC network cut-off
Dimensions		See diagram
Weight		0.056 kg
Standards		
Standards compliance		IEC 61643-11 / EN 61643-11 / IEC 61643-21 / EN 61643-21 / UL1449 ed.5
Certification		KEMA
Part number		838223